

DA-CM1100 INSTALLATION MANUAL

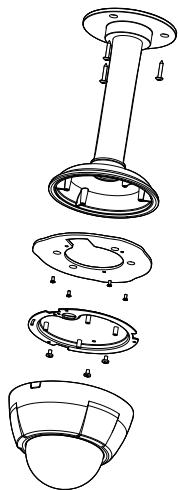

This manual is intended for users of the DA-CM1100 ceiling mounting bracket. It includes instructions for mounting the DA-CM1100 ceiling mounting bracket to a ceiling.



- **This bracket is intended to be used with DC-D series model of camera. Do not use it with other models of cameras.**
- **This installation should be performed by a qualified service personnel in conformance to all local codes.**
- **You may need to reinforce the ceiling. If the ceiling is not strong enough to support the camera, the camera may fall.**
- **Do not use this product for other purposes.**

Mounting

Mount the bracket to the ceiling as follows:

- 1 Insert cables from external devices, network and power adapter through the hole of bracket.
- 2 Mount bracket to the ceiling by using the anchors and screws.
- 3 Screw the plate to bracket by using the screws.

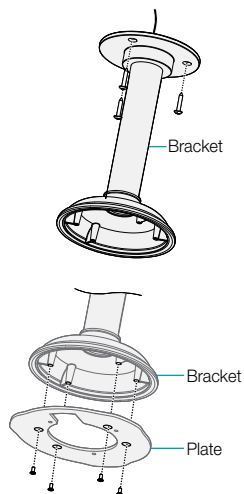

Connect your camera to the bracket as follows:

- 4 Screw the camera bottom cover onto the plate.
- 5 Connect the camera dome cover onto the camera bottom cover.
- 6 Turn on power.

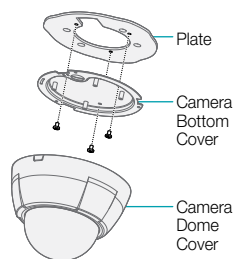

Dimensions

Unit: mm (inch)

